

Data sheet

# EZP-250(A) | Embedded Serial PPP Convert

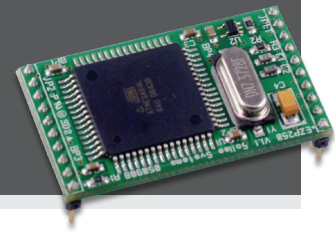

## Overview

EZP-250(A)是车载，移动型设备通过 CDMA,GPRS,HSDPA等PPP网远程传输数据的适用于PPP环境下的转换器。EZP-250(A)将与现有的串口设备连接做一下变动，方便的在因特网上连接。换句话说在TCP/IP 协议下传送数据时，自动处理数据，将没有TCP/IP技能的使用者设备轻松连接到因特网中。EZP-250(A)做为通过PPP提供TCP/IP通信的产品，将串口端与使用者的设备连接，另一端串口端口连接手机， TRS 终端机， dial-up 调制解调器等连接并使用我公司提供的命令与PPP连接后进行TCP或UDP通信的产品。

## Features

- PPP 用串口联网器
- 1 x UART (logic level) for DTE
- 1 x UART (logic level) for DCE
- 适于嵌入使用的超小型产品 34mm x 20mm
- 支持多样化的TCP/UDP主连接模态
- 支援使用简单并多样化的环境设定及通信技能的命令

## Application

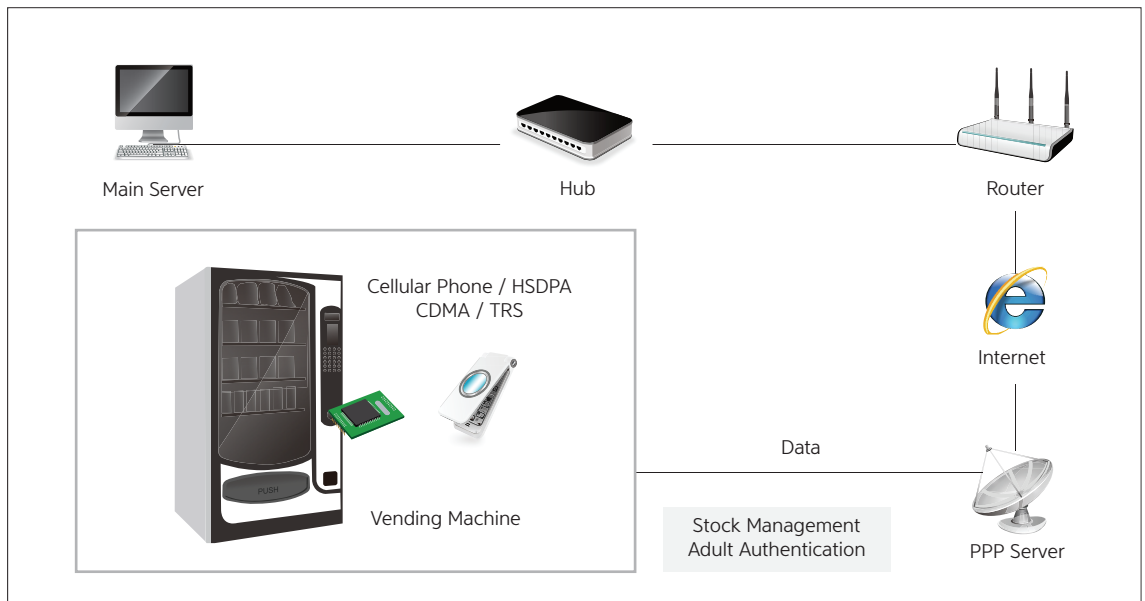

## System Diagram

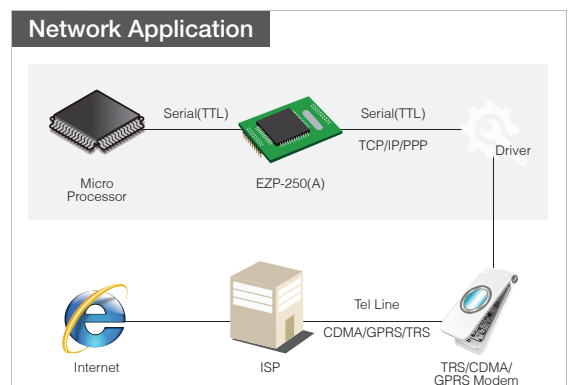
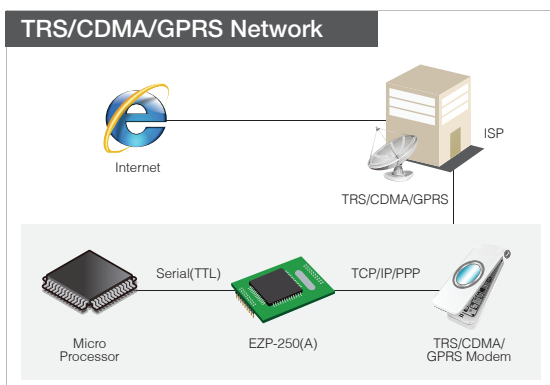

# Specifications

<b>Serial Physical Interface</b>	
<b>Serial Interface</b>	1 x UART, logic level - for DTE(Data Terminal Equipment) RXD, TXD, RTS, CTS, DTR, DSR, GND
<b>Connector</b>	2mm pitch male header
<b>Serial Port Properties</b>	
<b>Baudrate</b>	1200 bps ~230400 bps
<b>Data Bits</b>	8 bits
<b>Parity</b>	None
<b>Stop Bit</b>	1 bit
<b>Flow Control</b>	RTS/CTS Hardware (selectable by a command)
<b>Network Physical Interface</b>	
<b>Network Interface</b>	1 x UART, logic level - for DCE(Data Communication Equipment) PPP network
<b>Software Functions</b>	
<b>Protocols</b>	TCP, UDP, IP, ICMP, PPP
<b>Security</b>	PAP, CHAP
<b>Communication Mode</b>	TCP server
	TCP client
	UDP
	ICMP (ping)
<b>Processors</b>	
<b>CPU</b>	Atmel AVR
<b>ROM</b>	64K bytes Flash Memory
<b>RAM</b>	4K bytes SRAM
<b>Supplementary Software</b>	
<b>ezTerm</b>	Simple TCP/IP Communication Test Tool
<b>pflash</b>	Firmware Upgrade Utility for Windows
<b>ezVSP</b>	Serial to Network Virtual Driver for Windows
<b>Dimension</b>	
<b>Size</b>	34mm x 20mm
<b>Body Netweight</b>	about 4g
<b>Operating Environment</b>	
<b>Input Voltage</b>	DC 2.7V ~ 5.5V
<b>Power Consumption</b>	4mA (at 3.3V, idle state)
<b>Operating Temperature</b>	0°C ~ 70°C
<b>Storage Temperature</b>	-40°C ~ 85°C